

Products Tailored for Breweries, Wineries, and Distilleries!

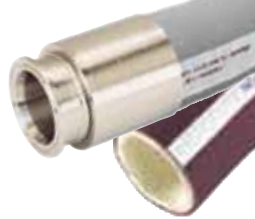

Check out our ever expanding website!

CUSTOM CRIMPED HOSE ASSEMBLIES

HOSES with the fittings you want!

John Perry, Bevel Seat, Q-Line, Tri-Clamp®, Butt-Weld, SMS, DIN, NPT and Camlock.

Novaflex 6506

Connoisseurs Food & Beverage Hose

Special kink and crush-resistant suction and discharge hose meets 3-A, FDA, USDA, and CFIA standards. Designed for demanding applications; temperature and chemical resistance. Features microbe-resistant tube on stainless steel mandrels for cleanliness in non-oily use.



Novaflex 6403 UHMW Tube

Food Suction and Discharge Hose

For specialized applications like food transfer, this rubber hose is flexible and has a white FDA-approved ultra-high molecular weight polyethylene grade tube. Built on stainless steel mandrels for cleanliness, its ultra-smooth, microbe-resistant tube ensures hygiene.



HOSE SUPPORT SYSTEM

Now offering a Hose Support System with a durable two-piece design and impact-resistant thermoplastic, it's lightweight yet tough. The safety yellow assembly easily bolts over hoses or stainless steel piping, lifting them off the floor to minimize wear and tear, maintain cleanliness, and protect sanitary connections. During washdown, it prevents damming, promoting efficient drainage and inhibiting bacterial growth. Its safety-focused design, featuring an easy-to-grab handle and high-visibility yellow coating, ensures a safer workplace. Experience the reliability and convenience of this hose support today!



WASH DOWN HOSE EXTRUDED 5/8"

Harco offers a Extruded Hose that is flexible, lightweight and easy to handle, yet it is heavy-duty. This versatile hose resists oil, abrasives and fatty and lactic acids, and are designed to handle a wide range of temperatures and work pressures for a variety of applications.

It does not include a spray nozzle, however any mixing units and spray nozzles can be purchased along with this hose assembly to build a complete wash down system.

Available with brass/stainless steel ends.

- Tube: FDA White & Black Nitrile
- Cover: Smooth extruded rubber
- Connections: 1/2" x 3/4" Male NPT swivels
- Working Pressure: 300 PSIG
- Maximum temperature: 200°F



LOW FLOW NOZZLES

HYDRO-PRO-150

Black, white, or red.

Heavyweight performance in a lightweight design! This water saver spray nozzle is ergonomically designed to reduce user fatigue. Stays cool even when using water as hot as 200°F.



M-70 SERIES

With swivel adapter. Black (M-70), white (M-75), or red (M-77).

Automatic Water Saver Spray Nozzles automatically shut off the moment the lever is released, thereby eliminating all waste of water.



DURAFLOW SPRAY NOZZLES

DH150

Navy, red, or white.

- Front trigger guard cover designed to prevent accidental spray.
- Trigger lock mechanism built in.
- Quick connect receptacle for accessories.
- Compatible with DuraWand.



SANITARY PUMPS - Flow Components Authorized Alfa Laval & Tetra Pak Distributor

The highly efficient pumps supplied by Harco provide precision pumping for all kinds of fluids with different viscosities, and the desired functionality for gentle and cost effective food production.



Stainless Steel SRU Pump



LKH Pump



DuraCirc® Pump

- Centrifugal
- Rotary Lobe
- Liquid Ring
- Positive



Twin Screw



Stainless Steel LKH Prime Pump



Large Inventory of OEM Spare Parts in stock.

Applications: Brewing, Dairy, Food, and Pharmaceutical Industries.

FOR MORE PUMPS, VISIT OUR WEBSITE AT <https://www.harcosupply.com/pumps/>

SANITARY VALVES - Flow Components Authorized Alfa Laval & Tetra Pak Distributor

The smart design of all valves supplied by Harco incorporate state of the art, precision engineered designs that meet or exceed current regulatory requirements. This category covers a wide range of valves for both sanitary, aseptic and non-sanitary applications.

- Unique - Mixproof - PMO
- Single Seat - SSV/7000 Series
- Shutter/Butterfly
- Regulating
- Sampling
- Automation
- LKC check valves

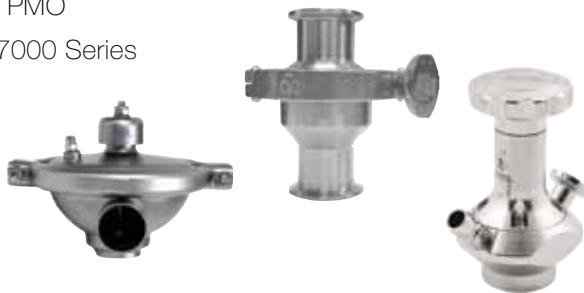

Applications: Brewing, Dairy, Food, and Pharmaceutical Industries.

FOR MORE VALVES, VISIT OUR WEBSITE AT <https://www.harcosupply.com/valves/>



Large Inventory of OEM Spare Parts in stock.

ThinkTops V20, V50 and V70 takes valve control to a new level and all these new features are available on any Alfa Laval diaphragm, butterfly, single-seat and mixproof valves.

Benefits:

- Automatic valve recognition
- Automatic selection of tolerance band
- Fast Auto, Live and Flex Setup
- 360-degree LED indication
- Burst seat clean
- Exchangeable (threaded) air-fittings
- Interchangeable with ThinkTop class

FOR MORE VALVES, VISIT OUR WEBSITE AT <https://www.harcosupply.com/valves/control-tops/>



HEAT EXCHANGERS

For Sanitary, Industrial, Process Applications

Harco gives you access to a wide range of compact plate heat exchangers that are especially designed for pasteurizing, and other kinds of heating and cooling of liquid foods.



BRAZED PLATE HEAT EXCHANGERS

Alfa Laval brazed heat exchangers are a compact and efficient solution for heating and cooling duties using water, evaporation and condensing, coolants, oil and refrigerants.

CB brazed plate heat exchangers provide high thermal efficiency.

Optimized for demanding duties, **Alfa Laval's patented AlfaNova** is a unique fusion-bonded heat exchanger made from 100% stainless steel.



Authorized Distributor  Tetra Pak



PLATES AND GASKETS

Harco provides plates, gaskets, and technical support for many brands of heat exchangers.

Whether you require individual components or complete packs, we meet your unique needs.



AIC - JAD LINE HEAT EXCHANGERS

Stainless Steel & Coil Heat Exchangers

JAD shell & coil heat exchangers are distinctly characterized by their angular connections, and by the concentric layers of helically corrugated tubes within the shell. Optimizing the performance and heat transfer efficiency of the units.

These JAD heat exchangers are primarily designed for vertical installations and can be installed in virtually any application where space is a constraint, due to their compact size.



MURZAN PI-50 PUMPS

The Air-Operated Double Diaphragm Pump

Harco offers the Murzan PI-50 diaphragm pump, uniquely tailored for sanitary industries like food and beverage, cosmetics, pharmaceuticals, and more. Constructed from premium Stainless Steel, the PI-50 allows easy disassembly for thorough inspection. It features a high-efficiency, oil-free air valve for optimal sanitation and safe transfer of products. Compliant with USDA, FDA, and 3-A standards, it ensures user safety and efficiency.

Contact Harco for your Murzan PI-50 Pump or replacement part inquires.



MURZAN
PUMPS & PROCESSING SYSTEMS

BÜRKERT VALVES Fluid Control Systems

Pneumatically operated 2/2-way angle seat valves

Type 2000 - CLASSIC The externally piloted angle seat valve is operated with a single or double-acting piston actuator, which is available in two different materials. The reliable self-adjusting packing gland provides high sealing integrity.

- Stainless steel or gunmetal housing with threaded, clamped or welded connection
- Long service life and maintenance-free
- High flow rates
- Robust actuators with modular accessory program

Type 2100 - ELEMENT for decentralized automation Optimised for decentralized process automation in process environments. Allows easy integration of automation units in all expansion stages. Self-adjusting v-seal packing gland. Integrated pilot air ducts and high resistance to chemicals.

- Flow-optimised stainless steel valve body with sleeve, clamp or weld connection
- Long service life and maximum service life
- High flow rates
- Suitable for steam



Type 2100



Type 2000

Authorized Distributor
bürkert
FLUID CONTROL SYSTEMS

ROLEC DH (Dry Hopping) Induction System

The simplicity of the ROLEC DH Provides Safe, and Efficient Hop Induction.



The ROLEC line **eliminates breweries safety concerns** of dry hopping on a ladder at the top of a tall fermenting tank. These **fully portable DH systems** powered by Ampco's in-line SBI shear blending pump are used at ground level.

The ROLEC dry hopping process maximizes pellet dispersion, flavor, and aroma. The increased surface area and forced contact produces dry hopped beer more efficiently than conventional methods – resulting in decreased tank-time and in many cases greater yield.

The SBI pump recirculates the fermenter while inducing dry hops and fruit, coffee, spices, nuts, honey, maple syrup and more, directly into the stream of beer; all from an oxygen free environment.

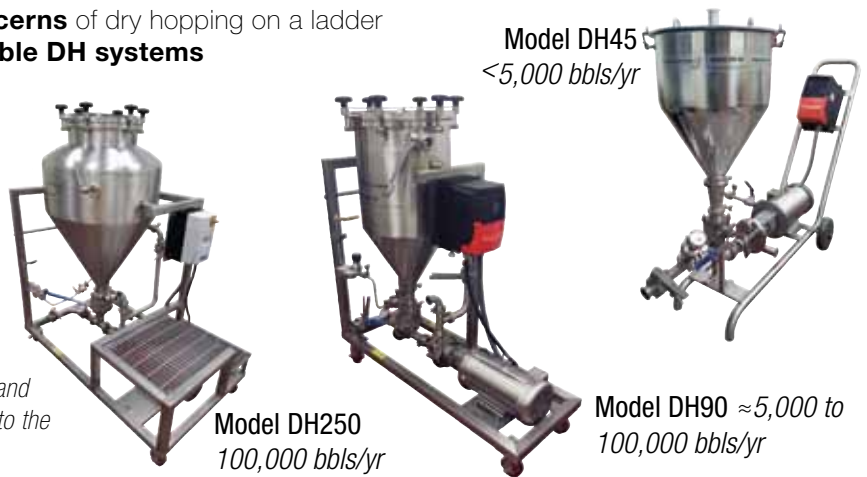

HIGH SHEAR INLINE MIXER

The SBI-R00 Cellar Cart makes it possible for small batch brewers to decrease tank time, improve flavor profile and increase shelf life.



The **SBI-R00** is a unique and portable **hop blending unit** with many advantages over conventional cellar carts when used for fermenter recirculation. Allows small scale brewers the ability to chop hop pellets, improve hop yield and increase surface area, while simultaneously recirculating the fermenter. Uses a 1.5 HP motor and VFD which can be operated using 115V single phase power.

There has been tremendous market response to the ROLEC DH 45/90/250 Dry Hop systems utilizing the SBI-R10 and SBI-R20 blenders.

Specifications

- 1.5 HP 3500 RPM Motor
- Available voltages - 115V, 208V, 230V, 460V, 575V
- Up to 40 GPM / 9 m³/hr or 1.3 bbls/min recirculation rate
- Up to 50 ft head / 22 psi / 1.5 BAR
- NEMA 4X VFD
- Input cord available
- Stainless steel 2 wheel cart
- Can be used as cellar pump



CB+ Craft Brew Pump

Newest Addition to the AC Series of Pumps

Ampco's new CB+ pump was designed specifically for the craft brewing industry and the aficionados who are passionate about creating their signature brews, not dealing with leaking pumps. Featuring a sanitary internal seal design that will keep seal faces cooler and minimize product buildup.

New CB+ pumps are hydraulically and dimensionally interchangeable with existing C Series pumps.

Ampco offers two CB+ conversion kits, allowing existing C Series and AC+ pumps to be converted to CB+ pumps.

Advantages:

- The internal seal is submersed in product to promote cooling
- Pressure within the pump creates a higher closing force on seal faces to minimize product buildup
- Internal spring agitates wort solids to avoid pooling on seal face



Ampco Pumps Company

CELLAR CART FOR BEER & CIP

Ampco's Cellar Cart is a lightweight, robust two-wheeled cart designed for maximum mobility. Constructed of stainless steel tubing, solid polypropylene wheels and is corrosion resistant. Built to customer specifications and can include any of Ampco's centrifugal pumps, positive displacement pumps, or blenders.



WINE & MUST CART Equipped with Ampco's ZP1 PD pump

Built to withstand harsh working environments – inside and out – this cart can stand up to whatever the application. Applications include wine and juice transfer, barrel work, filter, filling, and bottling supply.

Available in four standard model sizes. Options are available for each model.



Delivers Portable Transfer Technology

MADE-TO-ORDER Centrifugal Pump Carts

Harco's custom built **Centrifugal Carts** are lightweight, and a robust two-wheeled cart designed for maximum mobility. Constructed of stainless steel tubing, and corrosion resistant wheels. Built to customer specifications, and can include any of our centrifugal pumps listed below using the LENZE VFDS.



AMPCO PUMPS - AC+ & LF/
LC/LD Centrifugal Pumps

ALFA-LAVAL
- LKH,
LKH Prime &
SolidC Centrifugal
Pumps

Waukesha REPLACEMENT PARTS

**Cost Effective OEM Parts 100% Interchangeable
Guaranteed by Ampco!**

Save time and money with sanitary positive displacement replacement parts for your Waukesha Universal U1/U2 Series or any Ampco pump model.

We have a large stocked inventory of OEM sanitary pump spare parts you can confidently order replacement shafts, seal kits, alloy rotors, elastomers and more for quick delivery.



FLUX BARREL & CONTAINER PUMPS

FLUX barrel pumps and container pumps are suitable for pumping various thin, low-viscosity - also particularly aggressive and highly flammable - liquids. Due to the low weight of our barrel pumps, they can be easily carried from barrel to barrel. The simple handling of the motor and drum pump also enables short changeover times.

- F 560 FOOD eccentric worm-drive pump – for higher viscosity food



Bearing flange
version with
compressed-air
motor



Planetary
gear version
with three-
phase motor

PIPELINE GASKETS

*Large Inventory,
Competitive Prices!*

All styles and sizes are maintained in stock to ensure you fast delivery of the highest quality gaskets at all times. Closures, Dust Covers, Filters, Strainers, Clamp and other styles are all available.



Gaskets for All Sanitary
Processing Equipment.

SANITARY FITTINGS

These Hygienic Fittings meet the exacting demands for safety, reliability, efficiency and hygiene for standard duty in the food, dairy, beverage, personal care, biotechnology and pharmaceutical process applications.



HARCO GAUGES

**3½" and 5" Sanitary Pressure,
Homogenizer, & Pharmaceutical Gauges**

Harco's own line of pressure gauges has been designed specifically for the harsh environments found in the dairy and food processing applications.



Sanitary Gauges



Homogenizer
Gauges

Digital
Thermometers

COLOUR CODED BRUSHES AND PRODUCTS



Ultra Hygiene Squeegees



Deck-Wall Scrub Brushes



Hand Scrapers



Plastic Scoops



Plastic Shovels



Flat-Sided Pails & Lids

CFIA APPROVED SANITARY LUBRICANTS

For All Incidental Food Contact Food Processing Equipment



Haynes Spray
A light duty lubricant for fast application.



Haynes Silicone Spray



Haynes Lubri-Film
A heavy duty lubricant.



Petro-Gel
Purist of lubricants!
No. 1 Sanitary Lubricant Used In The Dairy Industry And Soft Serve Machines
Absolutely Tasteless & Odorless!



Harco Sanitary Spray HL-7
Contains no animal or vegetable fats.

Absolutely Tasteless And Odorless!

STAINLESS STEEL SHOVELS, PAILS, FORKS, PADDLES & UTENSILS

Certified NSF/ANSI Standard 2 Food Equipment. Constructed from heavy duty, type 304 stainless steel with an electropolished finish to enhance corrosion resistance, improve surface finish and for ease of cleaning. Ideal for use in the food processing industry.



Lubricating grease and oils with high load bearing, low friction properties for all incidental food contact food processing equipment.

Enquire today for a complete list of information and applications for these lubricants, along with many of our other lubricants available!!

CALL 1-800-361-5361 or VISIT
<https://www.harcosupply.com/lubricants/>

NOW OFFERING CIPRIANI HARRISON VALVES

Hygienic Stainless Steel Valves & Flow Components

Cipriani Harrison Valves are made for the Beverage, Food, and Dairy, Wine, Beer, Cosmetic, Pharmaceutical and Biotech industries.

11 Series Sanitary Plug Valves

These stainless-steel hygienic valves excel in installations where a sanitary closing or divert style valve is essential, coupled with the demand for minimal pressure drop.



33 Series Sanitary Sampling Valves

These stainless-steel hygienic sampling valves excel in both piping systems or tank installations.



Authorized Distributor



Cipriani Harrison Valves
Hygienic Stainless Steel Valves & Fittings

NORD DRIVESYSTEMS GEAR MOTORS Complete drive solutions from a single source

HARCO offers NORDs' versatile gear motors tailored for diverse applications across over 100 industries, including food & beverage and warehouse logistics. With high torque output and efficiency, these gear motors are customizable to meet specific needs, boasting millions of units worldwide delivering superior performance. Benefits include robustness, modularity, and adaptability with options like brakes and encoders. Our AC electric gear motors deliver up to 880,000 lb-in torque and run quietly with adjustable speeds. Specifically designed for the food industry, our gear motors are efficient, hygienic, and energy-saving.



STAINLESS STEEL MOTORS & DRIVE UNITS

HARCO offers a wide range of stainless steel motors and drive units to fit all pumps we supply. As well as TEFC Washdown protected or stainless-steel motors and drive units.



Harco has the ability to offer a complete customized package of pumps and motors assembled on a stainless steel base with VFD's to fit your specifications.

Harco distributes equipment and replacement parts for the following lines:



DeLaval



MUELLER



THOMSEN

Rubber Fab



STERLING ELECTRIC, INC.

WILDEN

JABSCO

WEARWELL



NOVAFLEX

CSE



COLUMBIA PRODUCTS



Endress+Hauser



SPARTA BRUSH

spirax sarco

3M



REMCO PRODUCTS



www.harcosupply.com

675 The Parkway,
Peterborough, Ontario K9J 7K2



800-361-5361
705-743-5361
sales@harco.on.ca