

## Trusted supply house to the dairy, beverage and food industries!



*Stainless-steel sanitary processing equipment, parts and supplies.*

1-800-361-5361 • 705-743-5361 • sales@harco.on.ca • www.harcosupply.com

## CUSTOM CRIMPED HOSE ASSEMBLIES

### HOSES with the fittings you want!

John Perry, Bevel Seat, Q-Line, Tri-Clamp®, Butt-Weld, SMS, DIN, NPT and Camlock.

#### Novaflex 6506

Connoisseurs Food & Beverage Hose

Special kink and crush-resistant suction and discharge hose meets 3-A, FDA, USDA, and CFIA standards. Designed for demanding applications; temperature and chemical resistance. Features microbe-resistant tube on stainless steel mandrels for cleanliness in non-oily use.



#### Novaflex 6403 UHMW Tube

Food Suction and Discharge Hose  
For specialized applications like food transfer, this rubber hose is flexible and has a white FDA-approved ultra-high molecular weight polyethylene grade tube. Built on stainless steel mandrels for cleanliness, its ultra-smooth, microbe-resistant tube ensures hygiene.



## HOSE SUPPORT SYSTEM

Now offering a Hose Support System with a durable two-piece design and impact-resistant thermoplastic, it's lightweight yet tough. The safety yellow assembly easily bolts over hoses or stainless steel piping, lifting them off the floor to minimize wear and tear, maintain cleanliness, and protect sanitary connections. During washdown, it prevents damming, promoting efficient drainage and inhibiting bacterial growth. Its safety-focused design, featuring an easy-to-grab handle and high-visibility yellow coating, ensures a safer workplace. Experience the reliability and convenience of this hose support today!



## WASH DOWN HOSE EXTRUDED 5/8"

Harco offers this heavy-duty Extruded Hose that is flexible, lightweight and easy to handle. This hose resists oil, abrasives, and fatty and lactic acids. It handles a wide range of temperatures and work pressures for a variety of applications.

A spray nozzle is not included, however any mixing units and spray nozzles can be purchased along with this hose assembly to build a complete wash down system.

#### Available with brass/stainless steel ends.

- Tube: FDA White & Black Nitrile
- Cover: Smooth extruded rubber
- Connections: 1/2" x 3/4" Male NPT swivels
- Working Pressure: 300 PSIG
- Maximum temperature: 200°F



## WASH DOWN MIXING STATIONS

### Steam & Water Mixing Stations

Steam and Cold Mixing Water Units, designed to produce hot water instantly from a steady supply of steam and cold water.

And is available in bronze or chrome-plated material.



**ARCHON**  
WD2010

## LOW FLOW NOZZLES

### HYDRO-PRO-150

Black, white, or red.

Heavyweight performance in a lightweight design! This water saver spray nozzle is ergonomically designed to reduce user fatigue. Stays cool even when using water as hot as 200°F.



### M-70 SERIES

With swivel adapter. Black (M-70), white (M-75), or red (M-77).

Automatic Water Saver Spray Nozzles automatically shut off the moment the lever is released, thereby eliminating all waste of water.



## DURAFLOW SPRAY NOZZLES

### DH150

Navy, red, or white.

- Front trigger guard cover designed to prevent accidental spray.
- Trigger lock mechanism built in.
- Quick connect receptacle for accessories.
- Compatible with DuraWand.



## SANITARY PUMPS - Flow Components Authorized Alfa Laval & Tetra Pak Distributor

The highly efficient pumps supplied by Harco provide precision pumping for all kinds of fluids with different viscosities, and the desired functionality for gentle and cost effective food production.

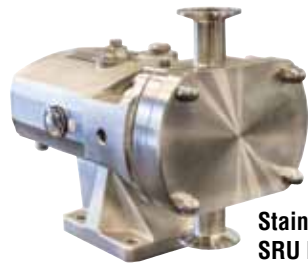

**Stainless Steel SRU Pump**



**LKH Pump**



**DuraCirc® Pump**

- Centrifugal
- Rotary Lobe
- Liquid Ring
- Positive



**Twin Screw**



**Stainless Steel LKH Prime Pump**



Large Inventory of OEM Spare Parts in stock.

**Applications:** Brewing, Dairy, Food, and Pharmaceutical Industries.

**FOR MORE PUMPS, VISIT OUR WEBSITE AT <https://www.harcosupply.com/pumps/>**

## SANITARY VALVES - Flow Components Authorized Alfa Laval & Tetra Pak Distributor

The smart design of all valves supplied by Harco incorporate state of the art, precision engineered designs that meet or exceed current regulatory requirements. This category covers a wide range of valves for both sanitary, aseptic and non-sanitary applications.

- Unique - Mixproof - PMO
- Single Seat - SSV/7000 Series
- Shutter/Butterfly
- Regulating
- Sampling
- Automation
- LKC check valves

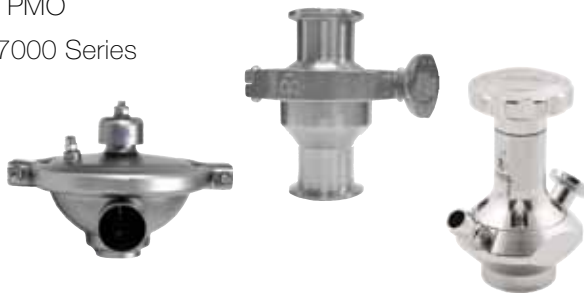

**Applications:** Brewing, Dairy, Food, and Pharmaceutical Industries.

**FOR MORE VALVES, VISIT OUR WEBSITE AT <https://www.harcosupply.com/valves/>**



Large Inventory of OEM Spare Parts in stock.

**ThinkTops V20, V50 and V70** takes valve control to a new level and all these new features are available on any Alfa Laval diaphragm, butterfly, single-seat and mixproof valves.

**Benefits:**

- Automatic valve recognition
- Automatic selection of tolerance band
- Fast Auto, Live and Flex Setup
- 360-degree LED indication
- Burst seat clean
- Exchangeable (threaded) air-fittings
- Interchangeable with ThinkTop class

**FOR MORE VALVES, VISIT OUR WEBSITE AT <https://www.harcosupply.com/valves/control-tops/>**



## SEPARATORS

### For Every Duty

Energy-efficient models with high quality standards for a wide spectrum of applications. An advanced inlet and outlet design ensures gentle treatment during the entire separation process.



- Milk Clarification
- Hot & Cold Milk Separation
- Whey Clarification
- Whey Cream Separation
- USDA Accepted Whey Clarifier
- Anhydrous Milk Fat
- Buttermilk Separation

## HOMOGENIZERS

### For Enhanced Product Quality

These machines are suitable for any process where high standards of hygiene and performance are essential.

Homogenizers have been associated with dairy products, but in recent years the food & beverage sector and many other industries have recognized the value of homogenization for enhanced product quality.



## HEAT EXCHANGERS

### For Sanitary, Industrial, Process Applications

Harco gives you access to a wide range of compact plate heat exchangers that are especially designed for pasteurizing, and other kinds of heating and cooling of liquid foods.

Harco gives you access to a wide range of compact plate heat exchangers that are especially designed for pasteurizing, and other kinds of heating and cooling of liquid foods.



Authorized Distributor  Tetra Pak



## PLATES AND GASKETS FOR ALL BRANDS

### Enhancing Heat Exchangers and Regasketing Solutions

Harco provides plates, gaskets, and technical support for many brands of heat exchangers.

Whether you need individual plates or complete plate packs, Harco caters to your unique heat exchanger requirements.

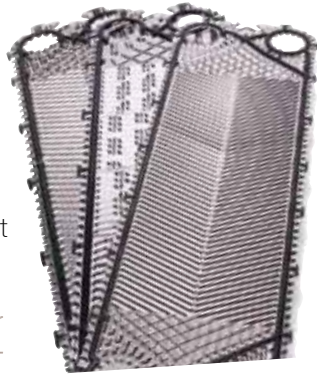

 Tetra Pak



## FLUX BARREL & CONTAINER PUMPS

FLUX barrel pumps and container pumps are suitable for pumping various thin, low-viscosity - also particularly aggressive and highly flammable - liquids. Due to the low weight of our barrel pumps, they can be easily carried from barrel to barrel. The simple handling of the motor and drum pump also enables short changeover times.

- F 560 FOOD eccentric worm-drive pump - for higher viscosity food



Bearing flange version with compressed-air motor



Planetary gear version with three-phase motor

## MURZAN PI-50 PUMPS

### The Air-Operated Double Diaphragm Pump

Harco offers the Murzan PI-50 diaphragm pump, the only pump specifically designed to meet the exact requirements of the sanitary industries such as the food and beverage, meat poultry and seafood, cosmetic, pharmaceutical and biomedical industries.

The Murzan PI-50 air-operated double diaphragm pump is built entirely of the highest quality Stainless Steel. The calculated design of the PI-50 allows for easy and complete disassembly to provide total visual inspection of all wetted parts.

Each Murzan PI-50 diaphragm pump is equipped with the high efficiency, non-lubricated, oil-free air valve, ensuring the most sanitary environment for your plant and your product. User safe and efficient transfer of foods, cosmetics and pharmaceuticals - USDA listed, FDA approved, the PI 50 Series is manufactured to meet general 3-A standards. **Contact Harco for your Murzan PI-50 Pump or replacement part inquires.**

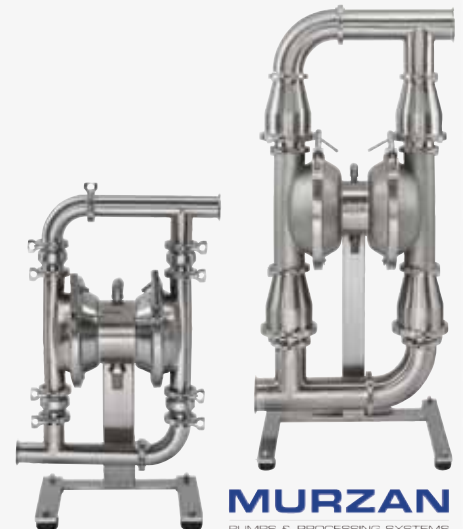

**MURZAN**  
PUMPS & PROCESSING SYSTEMS

# AMPCO SANITARY PUMPS Authorized Distributor

*Harco offers a wide range of sanitary Ampco centrifugal and positive displacement pumps for the dairy, food, beverage, and pharmaceutical industries.*

Ampco pumps are dimensionally and hydraulically interchangeable with other leading brands. And designed to offer easy maintenance and reduce processing down time. All new Ampco Pumps include a 304 stainless steel gear case.

Harco maintains a complete inventory of spare parts for all pumps. Save time and money with Ampco's spare centrifugal and PD parts. Harco's team is ready to assist with your next project.



**ZP Series Positive Displacement Pumps** (ZP1, ZP2, ZP3, & ZP4) are well suited for high and low viscosity applications.



LC SERIES Pumps

**LC/LD/LF Series Centrifugal Pumps** high-efficiency design and performance offers gentle product handling capability. **Fristam Replacement Pumps.**



**Sanitary AC+ Series Centrifugal Pumps** have a Unique Shaft Design Comparable to Competitor's More Expensive Models.



LF SERIES Pumps - front loading seal design.



**Bornemann SLH 5U Twin Screw Pump** offers gentle handling of soft solids and viscous products and is virtually pulsation-free.



**The SP Series self-priming Centrifugal Pump** is the perfect choice for aerated product transfer and CIP return.

Authorized Distributor for



## Waukesha REPLACEMENT PARTS

**Cost Effective OEM Parts 100% Interchangeable Guaranteed by Ampco!**

Save time and money with sanitary positive displacement replacement parts for your Waukesha Universal U1/U2 Series or any Ampco pump model.

We have a large stocked inventory of OEM sanitary pump spare parts you can confidently order replacement shafts, seal kits, alloy rotors, elastomers and more for quick delivery.



## MADE-TO-ORDER Centrifugal Pump Carts

Harco's custom built **Centrifugal Carts** are lightweight, and a robust two-wheeled cart designed for maximum mobility. Constructed of stainless steel tubing, and corrosion resistant wheels. Built to customer specifications, and can include any of our centrifugal pumps listed below using the LENZE VFDS.



**AMPCO PUMPS** - AC+ & LF/  
LC/LD Centrifugal Pumps

**ALFA-LAVAL**

- LKH, LKH Prime &  
SolidC Centrifugal Pumps

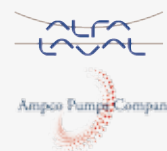

## SANITARY MIXING & BLENDING SOLUTIONS

**Harco offers a variety of mixers and blenders, from powder and ingredient systems to in-line blenders and mixers.**

Ampco Applied Products, a division of Ampco Pumps is fully committed to highly engineered blending and mixing solutions for a host of applications. Common industries served by the AAP product lineup are: dairy, chemical, pharmaceutical, brewing and personal care.



## BÜRKERT VALVES Fluid Control Systems

**Pneumatically operated 2/2-way angle seat valves**

*Authorized Distributor*



**Type 2000 - CLASSIC** The externally piloted angle seat valve is operated with a single or double-acting piston actuator, which is available in two different materials. The reliable self-adjusting packing gland provides high sealing integrity.

- Stainless steel or gunmetal housing with threaded, clamped or welded connection
- Long service life and maintenance-free
- High flow rates
- Robust actuators with modular accessory program

**Type 2100 - ELEMENT for decentralized automation** Optimised for decentralized process automation in process environments. Allows easy integration of automation units in all expansion stages. Self-adjusting v-seal packing gland. Integrated pilot air ducts and high resistance to chemicals.

- Flow-optimised stainless steel valve body with sleeve, clamp or weld connection
- Long service life and maximum service life
- High flow rates
- Suitable for steam



Type 2100

Type 2000

## PIPELINE GASKETS

*Large Inventory,  
Competitive Prices!*

All styles and sizes are maintained in stock to ensure you fast delivery of the highest quality gaskets at all times. Closures, Dust Covers, Filters, Strainers, Clamp and other styles are all available.



**Gaskets for All Sanitary Processing Equipment.**

## SANITARY FITTINGS

These Hygienic Fittings meet the exacting demands for safety, reliability, efficiency and hygiene for standard duty in the food, dairy, beverage, personal care, biotechnology and pharmaceutical process applications.



## HARCO GAUGES

**3½" and 5" Sanitary Pressure, Homogenizer, & Pharmaceutical Gauges**

Harco's own line of pressure gauges has been designed specifically for the harsh environments found in the dairy and food processing applications.



Sanitary Gauges



Homogenizer Gauges

Digital Thermometers

## COLOUR CODED BRUSHES AND PRODUCTS



Ultra Hygiene Squeegees



Deck-Wall Scrub Brushes



Hand Scrapers



Plastic Scoops



Plastic Shovels



Flat-Sided Pails & Lids

## CFIA APPROVED SANITARY LUBRICANTS

**For All Incidental Food Contact Food Processing Equipment**



**Haynes Spray**

A light duty lubricant for fast application.

**Haynes Silicone Spray**



**Haynes Lubri-Film**

A heavy duty lubricant.



**Petro-Gel**

Purist of lubricants!

No. 1 Sanitary Lubricant Used In The Dairy Industry And Soft Serve Machines

Absolutely Tasteless & Odorless!

**Harco Sanitary Spray HL-7**

Contains no animal or vegetable fats.



Absolutely Tasteless And Odorless!

## STAINLESS STEEL SHOVELS, PAILS, FORKS, PADDLES & UTENSILS

Certified NSF/ANSI Standard 2 Food Equipment. Constructed from heavy duty, type 304 stainless steel with an electropolished finish to enhance corrosion resistance, improve surface finish and for ease of cleaning. Ideal for use in the food processing industry.



Lubricating grease and oils with high load bearing, low friction properties for all incidental food contact food processing equipment.

**Enquire today** for a complete list of information and applications for these lubricants, along with many of our other lubricants available!!

**CALL 1-800-361-5361 or VISIT**  
<https://www.harcosupply.com/lubricants/>

# NOW OFFERING Ampco's ADU Sanitary Drum Unloading System Highly Efficient, Gentle and Cost-effective

Unload drums quickly and easily with up to 99% or better product removal when you use the ADU from Ampco Applied Products. The ADU utilizes the Bornemann SLH-4G sanitary twin screw pump paired with an inflatable drum seal suction head that stays secured to the edge of the drum as it moves down unloading the contents. The SLH-4G and included cleaning module are fully CIP-able.

The ADU sanitary drum unloading system offers greater energy efficiency when compared to air driven units. The main system utilizes an electrically powered pumping system and controls, requiring only a small amount of air to lift/lower and seal the bladder to the drum.

## DESIGN SPECIFICATIONS:

- 1-1,000,000 cP product
- Up to 30 gpm process
- 362 psi max discharge pressure
- CIP-able pumping rate 5-7 ft/sec

Authorized  
Distributor for  
**AMPCO**  
APPLIED PRODUCTS



## AMPCO'S IN-TANK MIXERS

### JET-mix

Ampco's in-tank JET-mixers will rapidly mix, disperse, and suspend solids in liquids covering a wide range of applications in food, personal care, clean chemical, and pharmaceutical industries. The modular construction of the JET-mix makes it ideal for a wide viscosity range and batch sizes up to 6,000 gallons in open or closed tanks, drums, and tote processing.



### JET-shear

Ampco's in-tank mixer is used to hydrate, dissolve, disperse and emulsify products consistently and efficiently. It covers a wide range of applications in the food, chemical and pharmaceutical industries. The JET-shear is used in open or closed tanks and totes, creating smooth consistent blends in tanks as large as 1,000 gallons. The JET-shear is much more than an in-tank agitator, capable of creating emulsions under 10 microns.



AMPCO  
APPLIED PRODUCTS

Harco distributes equipment and replacement parts for the following lines:



[www.harcosupply.com](http://www.harcosupply.com)  
675 The Parkway,  
Peterborough, Ontario K9J 7K2

**HARCO**  
ENTERPRISES LTD.

800-361-5361  
705-743-5361  
sales@harco.on.ca